

OUT OF THE DARKNESS

Shines

Bulbs **THAT LAST
4 EVER**



The Choice
of

LEADERS

FOR ALL TYPES OF

MOTORCYCLES

**BE BOLD!
BE BRIGHT!
BE SEEN!**

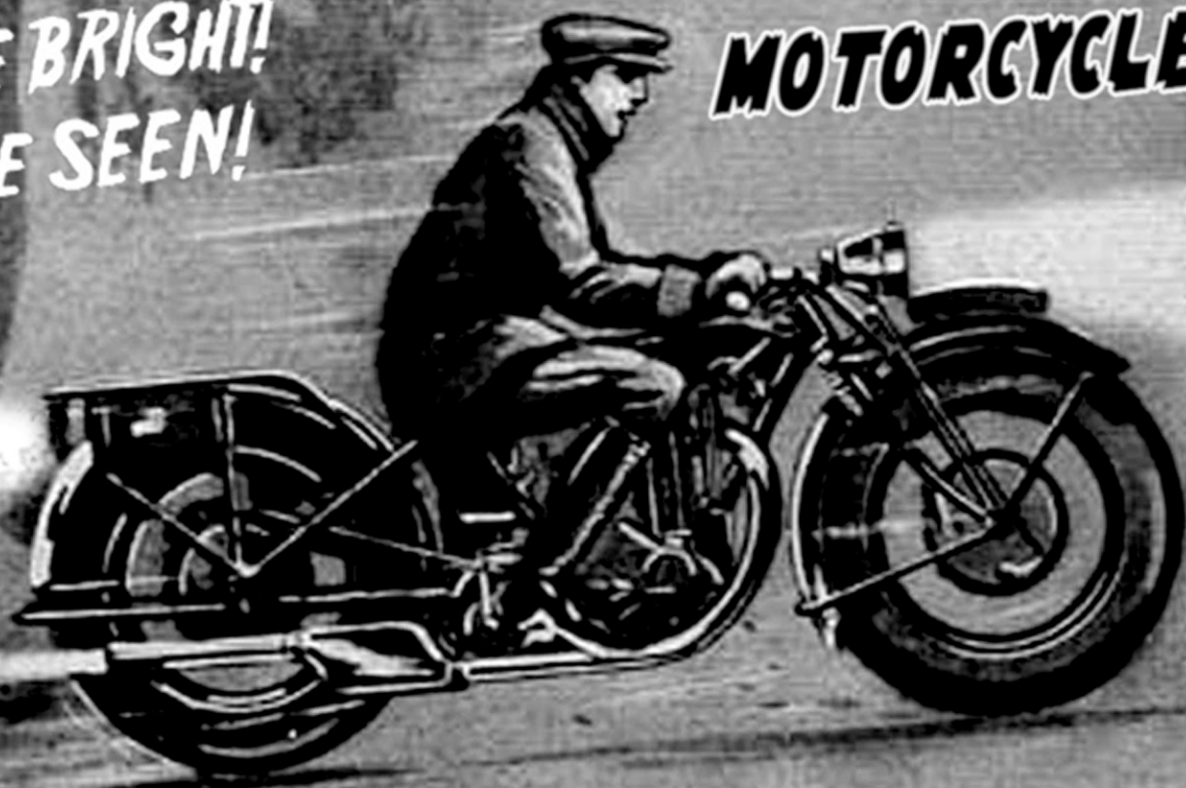

You can pay less elsewhere, but you will not reap the benefits enjoyed by 1000's of satisfied customers. Bulbs That Last 4 Ever utilises the highest quality materials available & is the only constructor that will create a unique lighting system specific to your needs. Visit our website & compare.

The proof is in the Illumination!

www.bulbthatlast4ever.com

LEFT BLANK INTENTIONALLY.

Model: CD1004-STD, Winker LED Conversion For Lucas Light Assemblies
Fit Brit Bikes from 1971-83 Installation Instructions:

Thank you for choosing the Bulbthatlast4ever™ CD1004 LED Winker Conversion Kit for your “Lucas Style” Winkers. This Kit has been designed for optimum installation in either genuine or reproduction Lucas winker assemblies as shown in Figure 2 of the Installation. A reproduction light assembly was used for all images shown and explanations discussed herein.

Before you start to install this kit, carefully read and follow these installation instructions for trouble-free installation. Expect the installation to take approximately 60-90 minutes, utilizing a #2 Philip screwdriver, Jeweler Screwdriver Set, Wire Cutter/Strippers, and some other basic hand tools.

Getting Started:

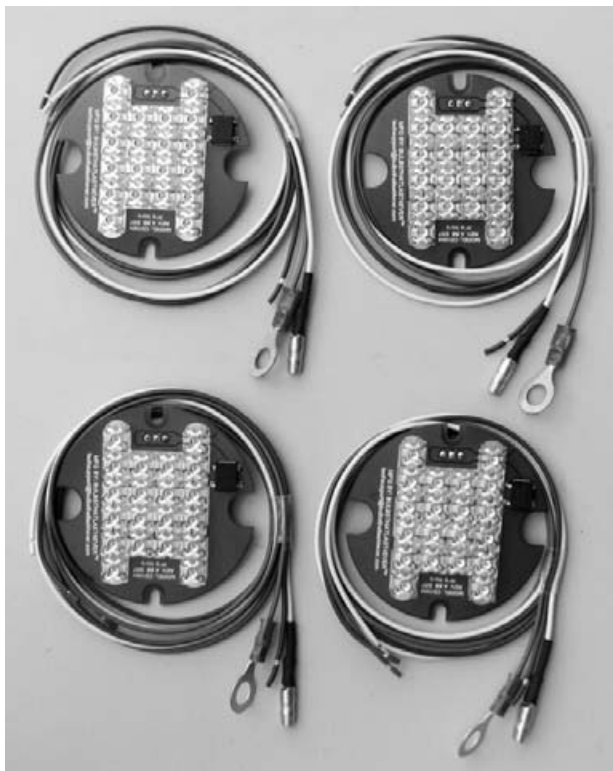

Basic Kit Shown Above

Figure 1

Kit Check List:

1. Qty 4, LED Boards
2. Qty 4, Set of 24” Wire Cable Assemblies (White, Green, and Brown)
3. Qty 1, BTL4E-005 “Pulsar-RL” Electronic Flasher Kit (Included, supplied as separate kit)

Notes: *This kit has been supplied with all the necessary items to install this kit. Some items may differ from any items shown or depicted anywhere in these installation instructions. Items are subject to change without notice at anytime.*

Disclaimer:

Under no circumstances will Bulbthatlast4ever or it's representatives be responsible or liable for any incidental or consequential property damages or personal injuries arising from or in connection with the use or installation of any of the listed foregoing products or devices. Rev. 9/08

Model: CD1004-STD, Winker LED Conversion For Lucas Light Assemblies
Fit Brit Bikes from 1971-83 Installation Instructions:

Installation:

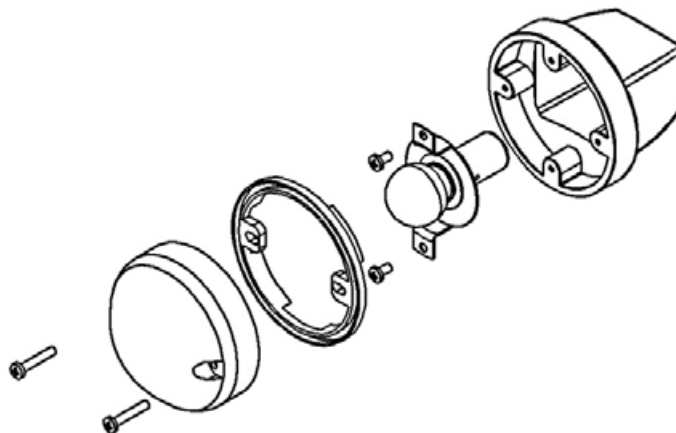

Figure 2

1. Disassemble all 4 winker light assemblies as shown in Figure 2 to start the installation. Be sure to remove the lens, gasket, bulb, and bulb socket assembly completely.



Figure 3

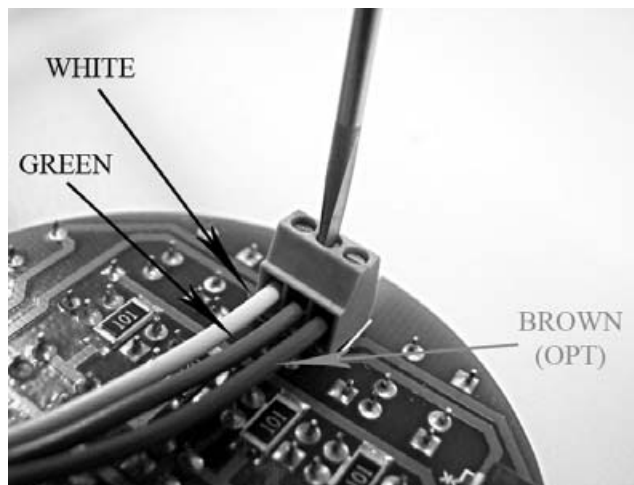

Figure 4

2. Feed all three wire assemblies for the front signals only and the White and Green wires for the rear signals, from the opposing end the winker stem feeding the wires into the housing as shown in Figure 3.
3. Pull the all the wires through until there's enough wire to comfortably reach the LED Board's terminal block openings while holding the LED Board in your hand. Insert the White Wire into the left opening of the terminal block, using a jeweler's screwdriver; tighten the screw until firmly seated. Insert the Green Wire into the center opening and tighten the screw. (Front) Running Light - Insert the Brown Wire into the last opening and tighten the screw. Refer to Figure 4 for more detail. ***Be sure to check your local laws regarding amber rear running lights before planning to use this option for rear signals.***

Disclaimer:

Under no circumstances will Bulbthatlast4ever or it's representatives be responsible or liable for any incidental or consequential property damages or personal injuries arising from or in connection with the use or installation of any of the listed foregoing products or devices. Rev. 9/08

Model: CD1004-STD, Winker LED Conversion For Lucas Light Assemblies
Fit Brit Bikes from 1971-83 Installation Instructions:

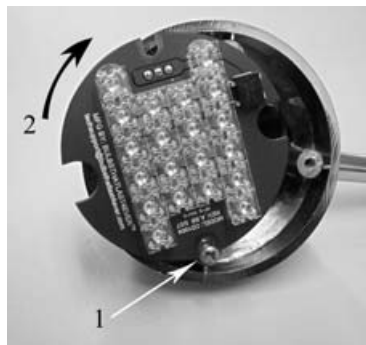

Figure 5



Figure 6



Figure 7

4. Install one of the 2 screws that were removed from the housing earlier into the bottom hole (1), then slip the bottom slot of the LED Board onto this screw. With the LED Board placed against the winker housing, rotate the board until the top screw hole is visible through the slot (2) then place the another screw into the hole. Refer to Figure 5 for more detail.
5. Tighten both the screws to secure the LED Board and then place the gasket as shown in Figure 6. The lens is now ready to be installed, install the lens to complete the conversion as shown in Figure 7. Repeat the above process for all remaining winker assemblies that still require to be converted.
6. Congratulations, you have successfully converted your “Winkers” to “LED Winkers”; they are now ready to be connected to the motorcycle’s wiring harness, see hook-up instructions in Table 1.

Wire Color	Function
White	Turn Signal
Brown	Running Light
Green	(+/-) Ground

**It's recommend that you ground to any screw or bolt to the chassis.*

Table 1

Flasher Unit Installation:

The Electronic Flasher/Running Light Unit (BTL4E-005 “Pulsar-RL”) has been supplied as a separate kit with its own set of instructions. Please refer to those separate installation instructions for further details and information.

On-line Technical Support available by e-mail at techsupport@bulbthatlast4ever.com

For Repairs>Returns, please visit this webpage first <http://bulbthatlast4ever.com/returns.html> or call our Help Line at (1) 818-239-2683 for returning instructions.

Warranty Info: See attached “Product Warranty Agreement” for more details.

Disclaimer:

Under no circumstances will Bulbthatlast4ever or it's representatives be responsible or liable for any incidental or consequential property damages or personal injuries arising from or in connection with the use or installation of any of the listed foregoing products or devices. Rev. 9/08



Product Warranty Agreement:

Bulbthatlast4ever warrants all our products, standard, custom, or otherwise against defects in material or workmanship as follows:

1. For a period of 365 days from the date of purchase if this Product is determined to be defective, Bulbthatlast4ever will repair the Product at no charge. After the 365 days period, you must pay a \$10 "Evaluation Charge", labor rate of \$15 per hour, and cost of replacement components. This warranty does not cover cost incurred in connection with the use of un-approved aftermarket accessories used with this Product.
2. To obtain warranty service, you must fill out a "Request for Repair" Form available on-line at <http://www.bulbthatlast4ever.com/returns.html> or call our Help Line at (1) 818-239-2683 for a "Return Merchandise Authorization" number and deliver the Product freight prepaid, in either its original packaging or packing affording an equal degree of protection, to Bulbthatlast4ever as per the information provided on the "Request for Repair" form or provided to you over the phone.

This warranty does not cover the following items listed herein, any implications of following items "WILL VOID" the Product warranty immediately and indefinitely, but are not limited to the listed below:

- Cosmetic damage or damage due to acts of God, accident, misuse, abuse, negligence, commercial use, improper use or maintenance, connection to improper voltage supply, or attempted repair by anyone other than a facility authorized by Bulbthatlast4ever to service this Product.
- Unauthorized customer or end-user modifications, such as grinding, filing, cutting, drilling, or by any other mechanical means with intent to alter the shape or size of the printed circuit board assembly/ies.
- Installation of non-factory approved replacement parts soldered into the printed board assembly/ies such as but not limited to resistors, LEDs, headers, or any other electronic component active or passive used in or on our products. In the case of printed circuit board assembly/ies with factory omitted components, inserting and soldering components or anything into these locations.
- Improper handling of Class I or Class II ESD (Electro-Static Discharge) rated components as per the individual component manufactures handling procedures or datasheet.
- Any damage received to any of the electrical pathways (traces) of the printed circuit board assembly/ies by one more but not limited to the following means, electrical overload, mechanical interference, environmental conditions, deliberate damage inflicted by human or any man-made machine, and/or improper installation of the product.
- Any damage received to the printed circuit board assembly/ies that has resulted due to contact with any type of liquid or fluid, natural or otherwise, but not limited to the following examples, water (fresh or salt-water), gasoline (petrol), any petroleum based products, solvents or cleaners used outside of the manufacturing process.
- Damages that are sustained by accidental damaged such as being involved in a motor vehicle accident of any kind. Accidental dropping the product onto any surface harder than the printed circuit board assembly/ies or its components.
- Damages that may occur from a vehicle's electrical or charging system that is found not to be properly functional to the manufactures specifications.

Proof of purchase in the form of a bill of sale, receipt invoice, or vendor sales slip which is evidence of that the unit is within the Warranty period must be presented to obtain warranty service.

Bulbthatlast4ever reserves the right to refuse any product warranty based on any reason listed above. Bulbthatlast4ever also reserves the right to honor or refuse any warranty repair for any reason based upon any signs or suspicion of product tampering to the above-mentioned Product.